

Infinite™ 6A

Category 6A UTP Keystone Jack

Features:

- High-performance data communications Cat 6A UTP Jack
- Comply with Cat 6A standards:
ANSI/TIA/EIA 568C
ISO/IEC 11801:2002 Class E_A
- Molded Category identification on jack
- EIA 568A/B wired
- UL 1863 safety listed
- UL94V-0 fire retardant plastic
- RJ-45 keystone type

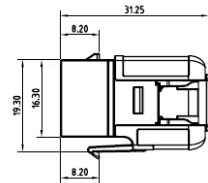
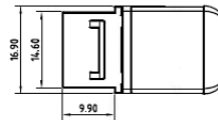
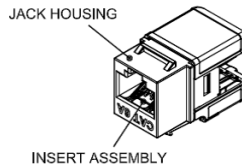

Characteristic:

Electrical	
Dielectric Voltage	1000V d.c.
Insulation Resistance	500M ohm min. @ 100V d.c.
IDC Contact Resistance	2.5 m ohm max.
Environmental	
Storage	-40° to +85°C
Operation	-10° to +70°C

Mechanical	
Housing Material	Flame Retardant ABS UL94V-0 Rated
IDC Contact Material	Tinned Phosphor Bronze Pins
RJ-45 Jack Operating Life	Min 750 Cycles
IDC Operating Life	Min 200 Reterminations
Wire	AWG 22-24

Performance:

Bandwidth	RL	Attenuation	NEXT	ACRF
	dB	dB/100m	dB	dB
500 MHz	>6.0	<49.3	>26.1	>9.3

Ordering Information:

Order no.	Description
IN6A-401-WH	Cat 6A UTP RJ-45 Keystone Jack, 568A/B, White Color



* Infinite Cable System reserves the right to modify products and specifications without prior notice.